

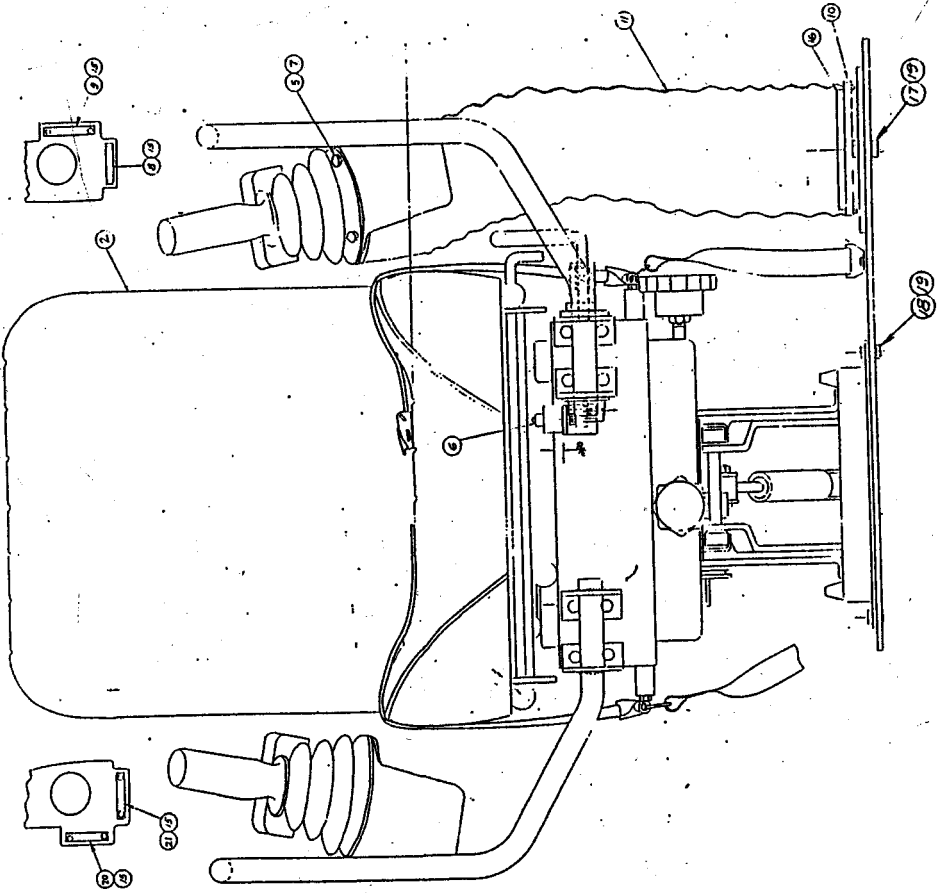

OPERATOR'S COMPARTMENT

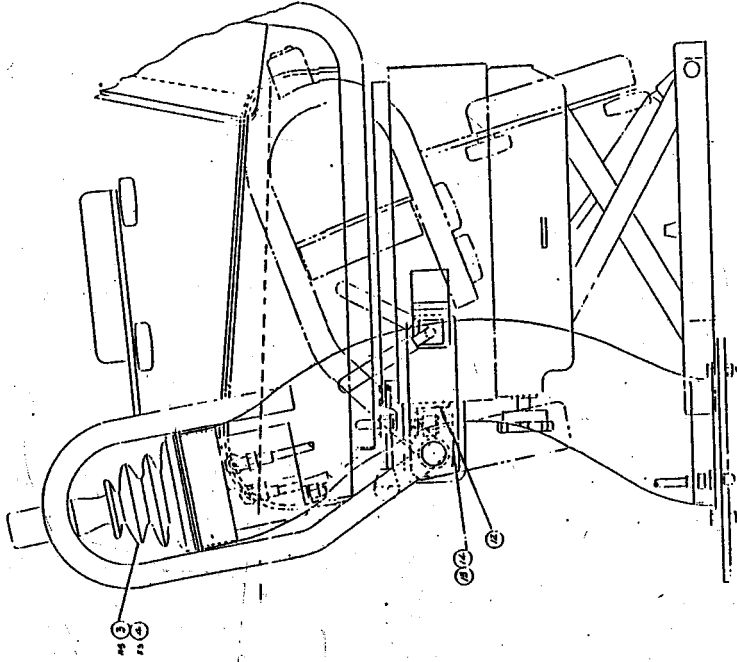

① ASSY

SWINGMASTER CORPORATION

PARTS BOOK

MACHINE	SECTION	15
MODEL 181 SWINGLOADER	OPERATOR'S COMPARTMENT	

ASSEMBLY
NUMBER

DESCRIPTION

1801242

SEAT INSTALLATION

ITEM NO.	PART NUMBER	DESCRIPTION	QTY. USED
2	1800213	OPERATOR'S SEAT	1.00
3	1800112	JOYSTICK - SWING L-R / ATTACHMENT	1.00
4	1800111	JOYSTICK - BOOM UP-DOWN/BUCKET DUMP-LOAD	1.00
5	1800430	H.H.C.S. 1/4-20 X 1/2" LONG	8.00
6	1800218	SEAT SWITCH	1.00
7	1800567	1/4" LOCK WASHER	8.00
8	1801298	DECAL (SWING L-R)	1.00
9	1801299	DECAL (ATTACHMENT)	1.00
10	1800694	5 1/2" HOSE CLAMP	4.00
11	1800188	BULK EXHAUST HOSE - 5" ID (IN)	48.00
12	1801297	SWITCH MOUNTING ANGLE	1.00
13	1801300	LEVER WELDMENT	1.00
14	1801303	ROLL PIN 3/16" X 1 1/2" LG	1.00
15	1800845	1/8" POP RIVET	8.00
16	1800844	BULKHEAD WELDMENT	2.00
17	1800451	H.H.C.S. 3/8-16 X 3/4" LONG	4.00
18	1800454	H.H.C.S. 3/8-16 X 1 1/4" LONG	4.00
19	1800568	3/8" LOCK WASHER	8.00
20	1801301	DECAL (BOOM UP - DOWN)	1.00
21	1801302	DECAL (BOOM DUMP - LOAD)	1.00

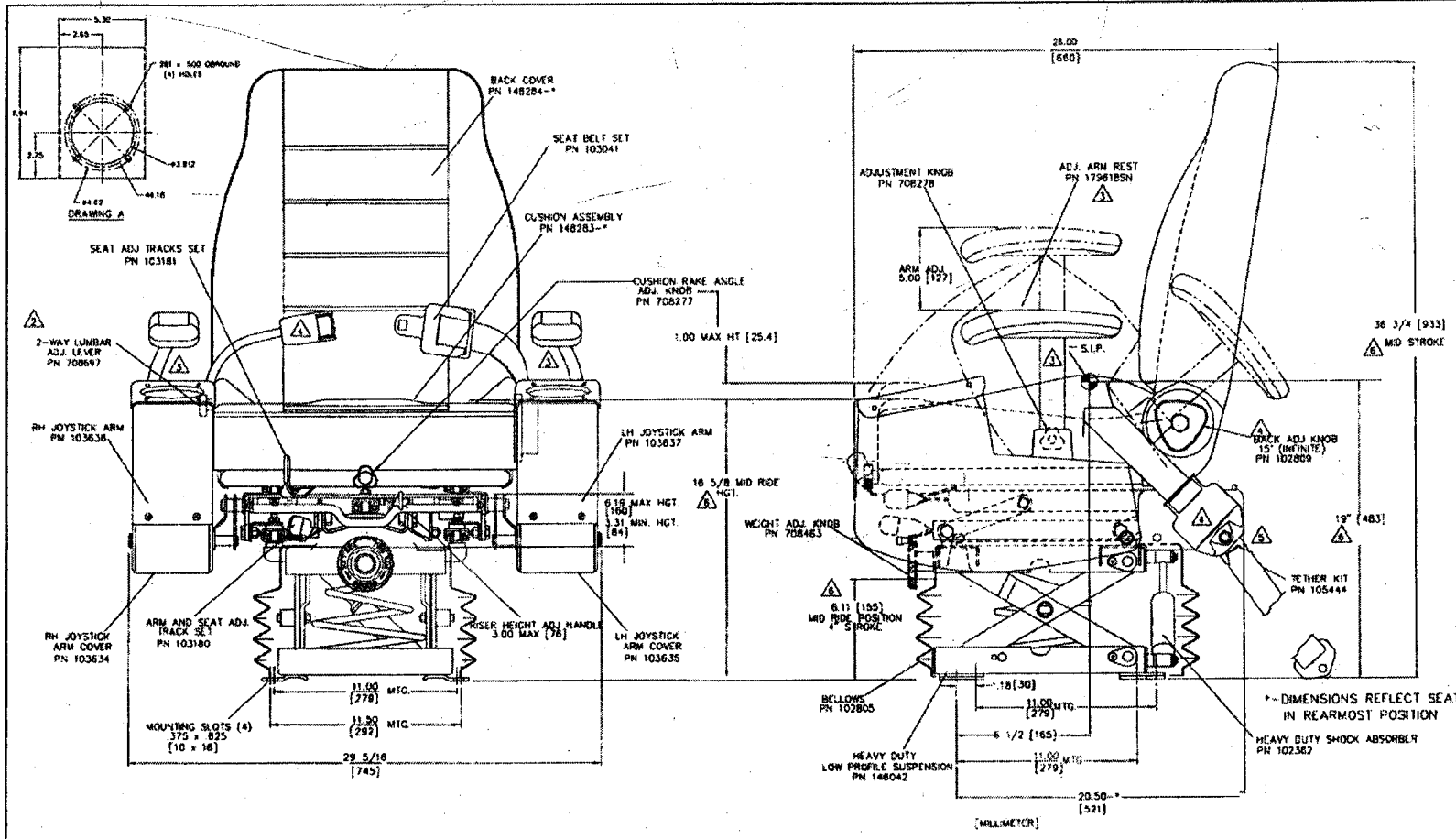

- NOTE:
- 1) ILLUSTRATED VIEW MAY VARY IN SHAPE AND APPEARANCE DUE TO CHANGING MATERIALS AND DESIGN
 - 2) DUAL SETS OF TRACKS ALLOW 8" OF TRAVEL OF ARMS AND SEAT AND 3" OF TRAVEL OF SEAT ALONE - TRACKS ARE SHOWN IN NEUTRAL POSITION
 - 3) CONTROLLER ARMS ROTATE BY UPWARD AND CAN INCORPORATE AN OPTIONAL ROLL SWITCH THAT ACTIVATES WHEN ARMS ARE UPFOLD
 - 4) THE SEAT CUSHION HAS A RAKE ANGLE ADJUSTMENT OF 1" IN HEIGHT
 - 5) ALL DIMENSIONS SHOWN ARE FOR AN UNOCCUPIED SEAT
 - 6) DIMENSIONAL TOLERANCES ARE ± .0012 [] UNLESS OTHERWISE SPECIFIED
 - 7) S.I.P. DIMS PER SAE J1183 (NEUTRAL TRACK, MID HEIGHT & MID SUSPENSION SERVICE)
 - 8) TOTAL HGT ADJ. MOVES SEAT 3" FWD & 3" UP FROM LOW POSITION

EFF DATE: 10/23/09

PATENT NUMBERS
 U.S. # 5,078,528

PLEASE NOTE:
 This drawing pertains to Seats, Inc. Hardware, Inc. & is confidentially held and its disclosure to the public is prohibited. It is the property of the inventor and shall remain so until it is made a part of the public domain. It is not to be used in any way without the written consent of Seats, Inc. or any agent thereof. A license to use this drawing is granted to the licensee on the condition that the licensee shall not disclose the contents of this drawing to any third party without the written consent of Seats, Inc. or any agent thereof.

REV	DATE	DESCRIPTION	BY	APPROVED
1	05/12/92	REVISED AND IMPROVED		
2	05/12/92	REVISED AND IMPROVED		
3	05/12/92	REVISED AND IMPROVED		
4	05/12/92	REVISED AND IMPROVED		
5	05/12/92	REVISED AND IMPROVED		
6	05/12/92	REVISED AND IMPROVED		
7	05/12/92	REVISED AND IMPROVED		
8	05/12/92	REVISED AND IMPROVED		
9	05/12/92	REVISED AND IMPROVED		
10	05/12/92	REVISED AND IMPROVED		

seats INCORPORATED

CONTROLLER SEAT W/ "A" MTC LPS

173916