



SECTION O
OPERATOR'S COMPARTMENT

MACHINE	SECTION	15
MODEL 361 SWINGLOADER	OPERATOR'S COMPARTMENT	

ASSEMBLY	DESCRIPTION
NUMBER	
1801260	TOOL KIT

ITEM	PART		QTY.
NO.	NUMBER	DESCRIPTION	USED
1	1801269	SPECIAL SOCKET WRENCH	1.00
2	1801270	PLIER	1.00
3	1801271	SCREW DRIVER	1.00
4	1800370	WRENCH	1.00
5	1800371	HANDLE	1.00
6	1800375	GREASE GUN	1.00
7	1800377	GREASE GUN HOSE	1.00
8	1801069	3/8" FEMALE COUPLER BODY	1.00

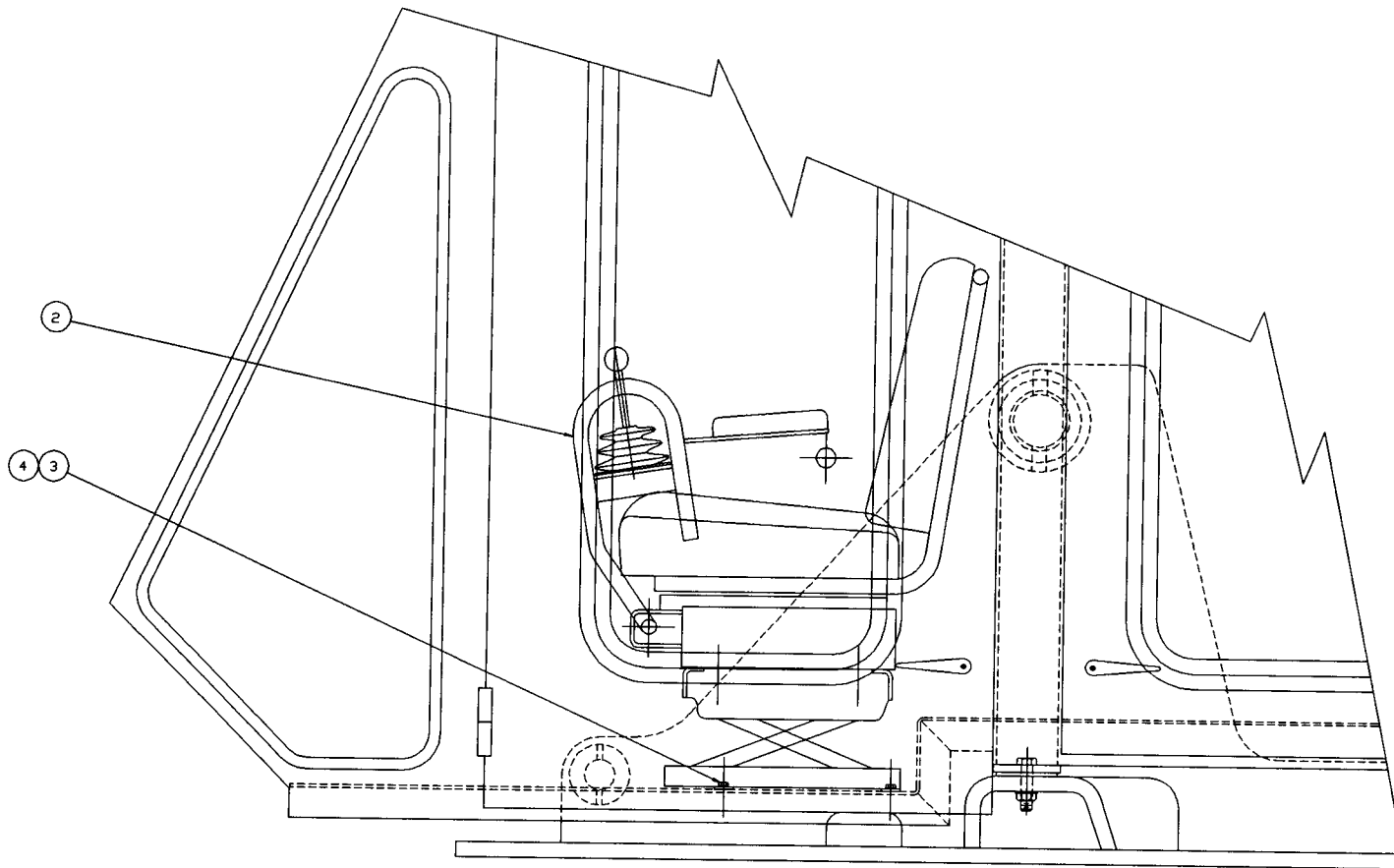

1 INSTALLATION

TOLERANCES
 UNLESS OTHERWISE SPECIFIED
 FRACTIONS +/-
 3 PLACE DECIMALS +/-
 2 PLACE DECIMALS +/-
 1 PLACE DECIMALS +/-
 ANGLES
 SEE SWINGMASTER SPECIFICATION
 G-1 FOR TOLERANCES NOT SPECIFIED
 DIMENSIONS ARE IN INCHES
 DO NOT SCALE DRAWING
 SCALE: 1/4

SWINGMASTER CORPORATION
 11415 MELROSE AVENUE
 FRANKLIN PARK, ILLINOIS 60131
 SEAT INSTALLATION
 FOR MODEL 361
 DRAWN BY: J.K. DRAWING NO. D-226
 DATE: 11-22-88

MACHINE _____ SECTION _____ 15.

MODEL 361 SWINGLOADER OPERATOR'S COMPARTMENT

ASSEMBLY
NUMBER DESCRIPTION

1802203 SEAT INSTALLATION

ITEM PART			QTY.
NO. NUMBER	DESCRIPTION		USED
2	1800213	OPERATOR'S SEAT	1.00
3	1800454	H.H.C.S. 3/8-16 X 1 1/4" LONG	4.00
4	1800568	3/8" LOCK WASHER	4.00

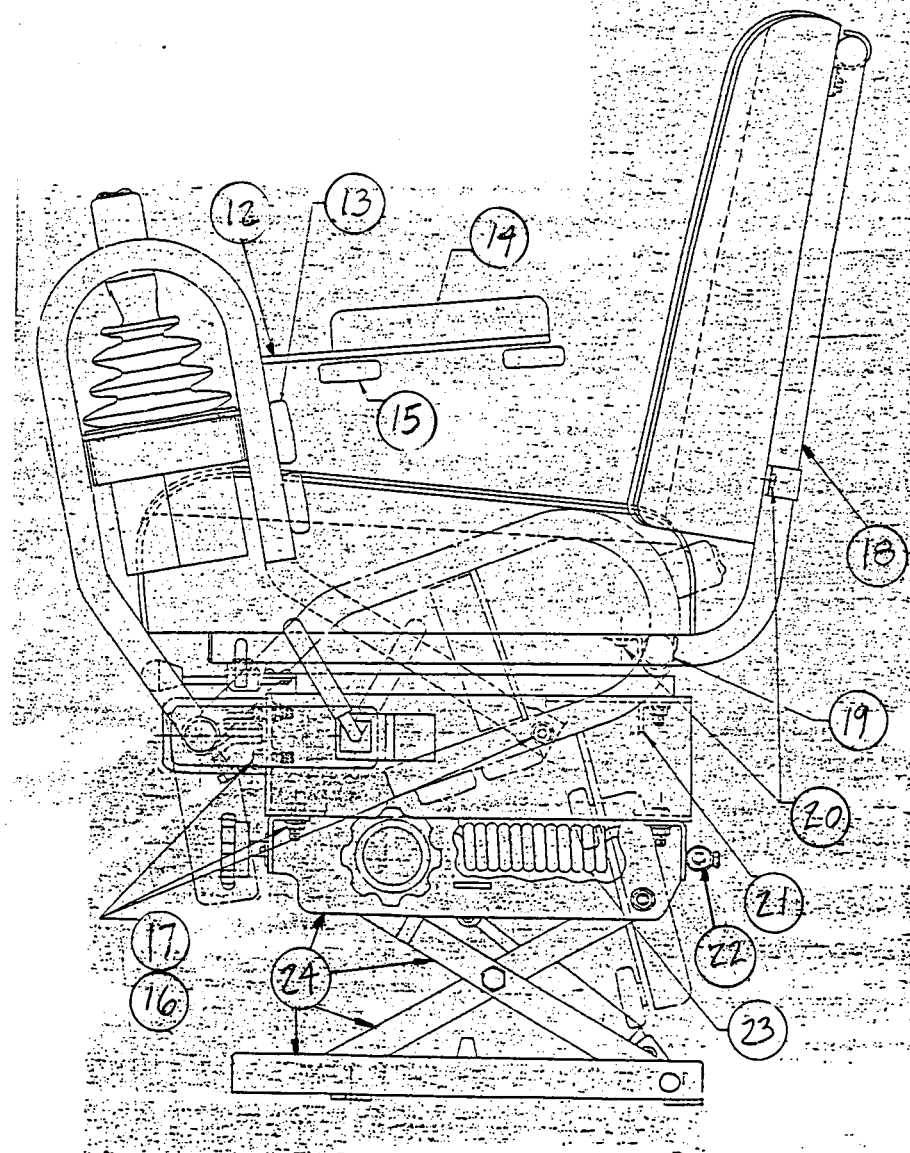
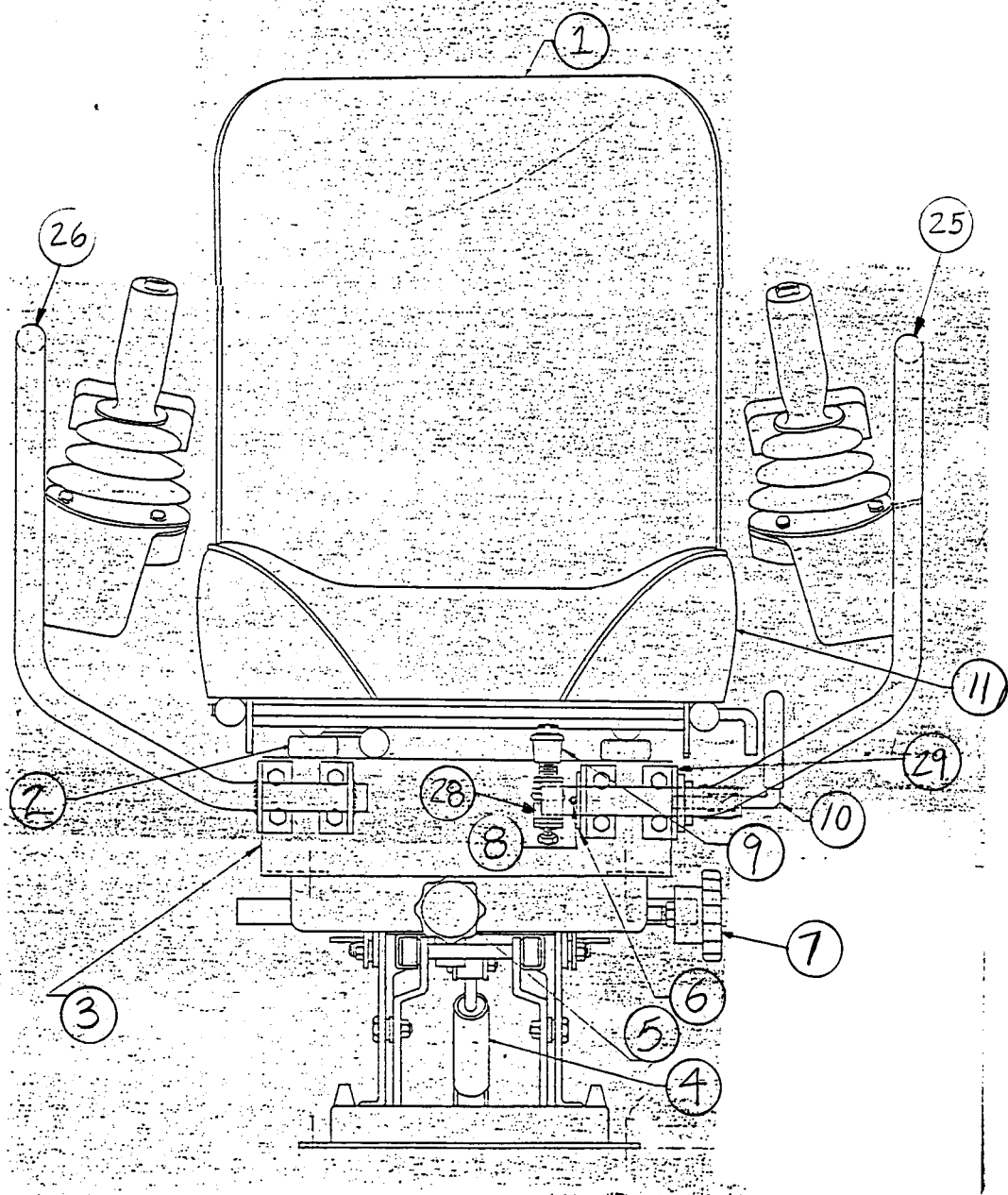

MACHINE _____ SECTION _____ 15

 MODEL 361 SWINGLOADER OPERATOR'S COMPARTMENT

ASSEMBLY
 NUMBER DESCRIPTION

 1800213 OPERATOR'S SEAT

ITEM PART NO. NUMBER DESCRIPTION	QTY. USED
1 8701120 BACK CUSHION	1
2 8701121 CONTROL TRACK	1
3 8701122 JOYSTICK ARMS WITH SPACER HOUSING ASSY INCLUDES ITEMS 8,9,10,16,17,21,25,26	1
4 8701123 SHOCK ABSORBER	1
5 8701124 PLASTIC KNOB	1
6 8701125 WASHER	1
7 8701126 PLASTIC KNOB	1
8 8701127 EXPANSION PIN	1
9 1800218 SEAT SWITCH	1
10a 8701128 EXPANSION PIN - FOR LOCKING MECHANISM	1
10b 8701129 SPRING - FOR LOCKING MECHANISM	1
10c 8701130 LATCH ACTIVATOR - FOR LOCKING MECHANISM	1
10d 8701131 LATCH HANDLE - FOR LOCKING MECHANISM	1
10e 8701132 END TIP	1
11 8701133 SEAT CUSHION	1
12 8701146 ARM BRACKET	1
13 8701134 PLASTIC KNOB - FOR ARM BRACKET	2
14 8701135 ARM CUSHION	4
15 8701136 PLASTIC KNOB - FOR ARM CUSHION	2
16 8701137 CAP SCREW	4
17 8701138 HEX NUT	13
18 8701139 SEAT FRAME	17
19 8701140 CLAMP	1
20 8701141 CAP SCREW	5
	5

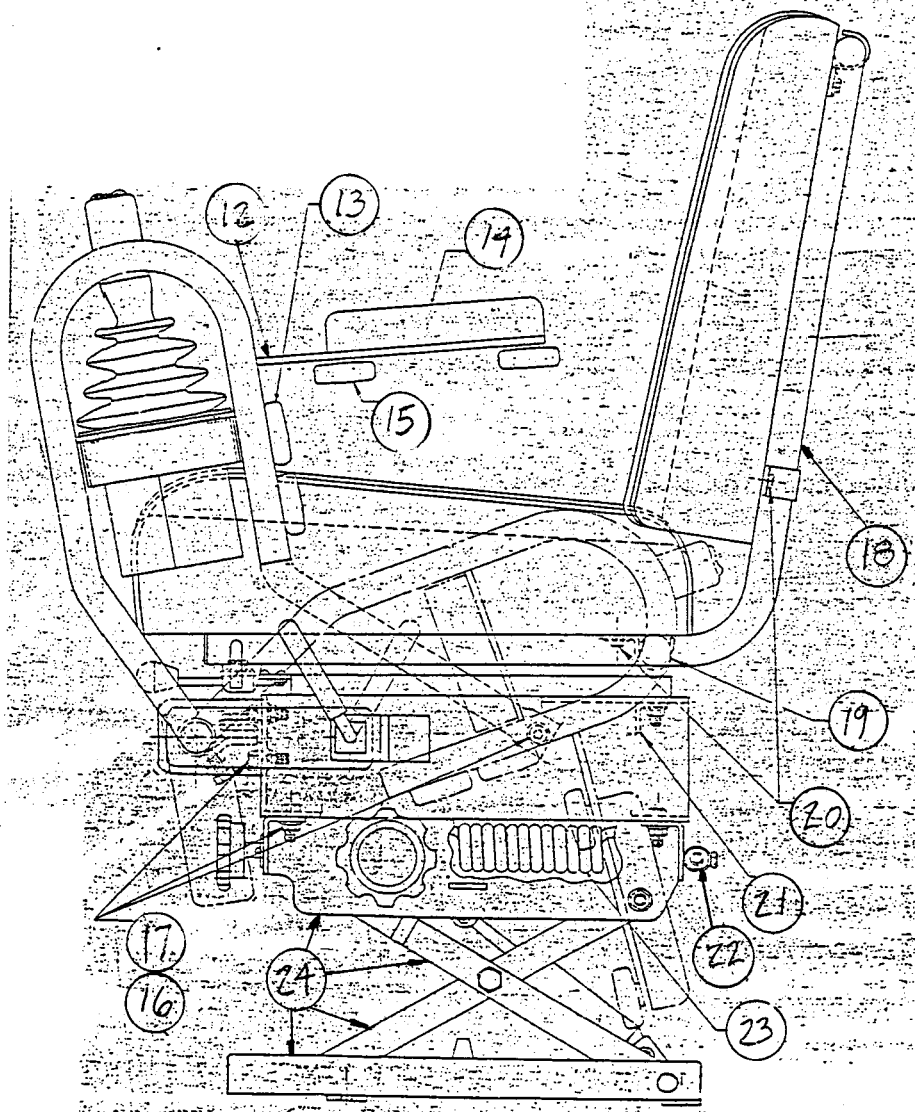
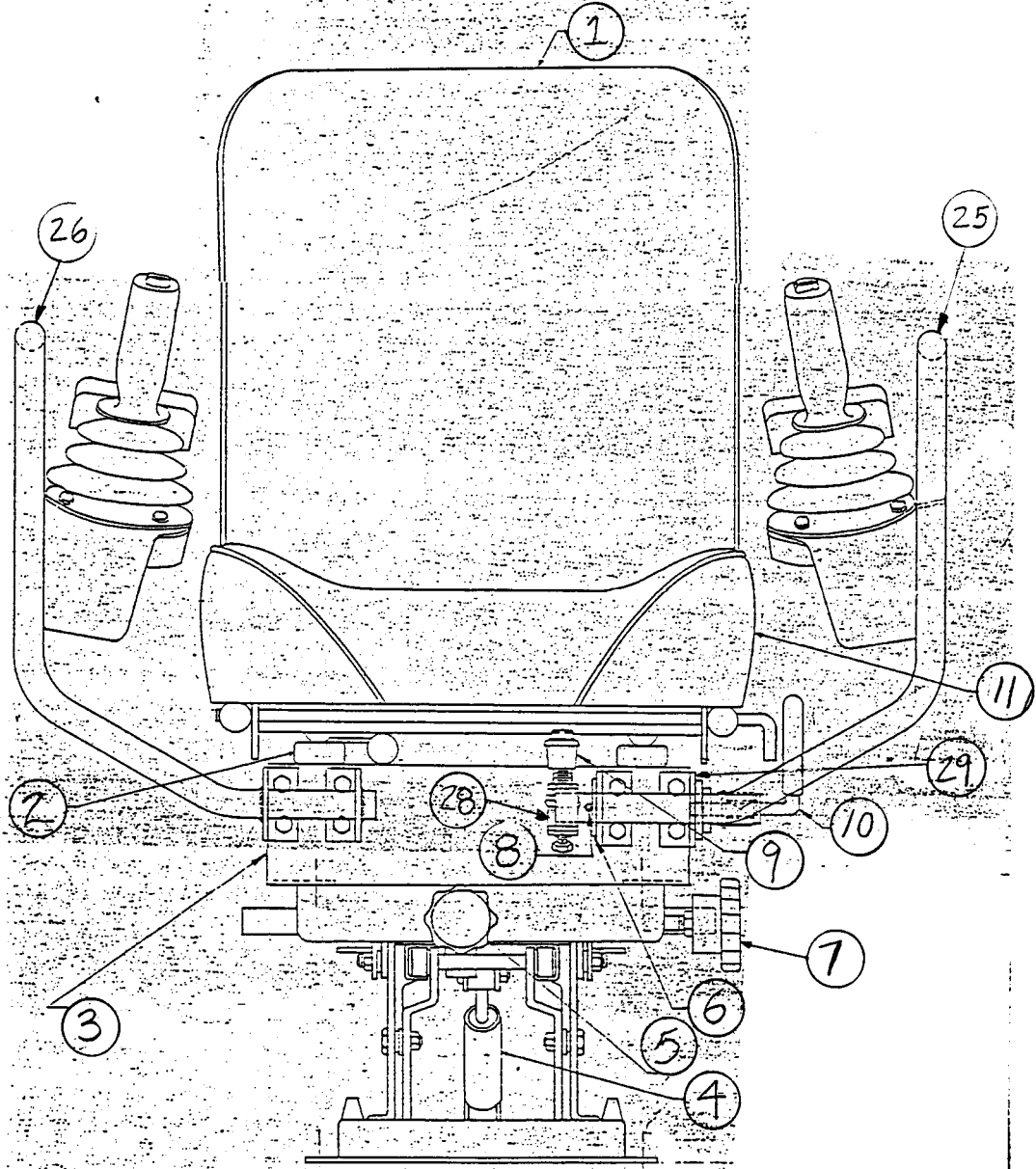

MACHINE	SECTION	15
-----	OPERATOR'S COMPARTMENT	-----
MODEL 361 SWINGLOADER		
-----		-----

ASSEMBLY	DESCRIPTION
NUMBER	

1800213	OPERATOR'S SEAT
-----	-----

ITEM	PART		QTY.
NO.	NUMBER	DESCRIPTION	USED
21	8701142	SUPPORT BRACKET	1
22	8701145	SEAT BELT BRACKET	1
23	8701143	SPRING	1
24	8701144	SEAT SUSPENSION ASSEMBLY	1
		INCLUDES ITEMS 4,5,7,23	
25	8702097	LEFTHAND JOYSTICK ARM	1
		INCLUDES ITEMS 6 & 8	
26	8702098	RIGHTHAND JOYSTICK ARM	1
27	8702099	SEATBELT - NOT SHOWN IN PICTURE	1
28	8703623	ANGLE	2
29	8703624	SWITCH ACTIVATOR	1

SWINGMASTER CORPORATION
 11415 MELROSE AVENUE
 FRANKLIN PARK, ILLINOIS 60131

TELEPHONE: (847) 451-1224

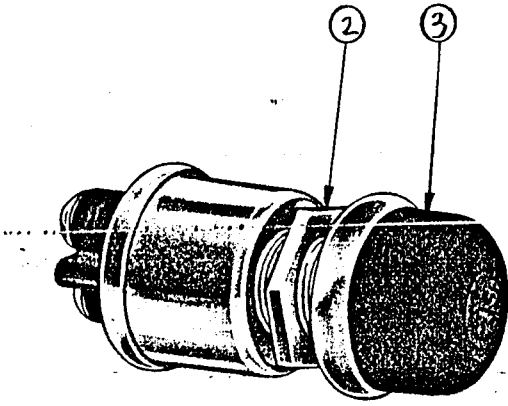

① ASSEMBLY

SWINGMASTER CORPORATION

PARTS BOOK

MACHINE

SECTION

15

MODEL 361 SWINGLOADER

OPERATOR'S COMPARTMENT

ASSEMBLY
NUMBER

DESCRIPTION

1800218

SEAT SWITCH ASSEMBLY

ITEM PART

QTY.

NO. NUMBER DESCRIPTION

USED

2 8700740 HEX NUT

1

3 8700741 RUBBER CAP - WITH MOUNTING NUT

1

SWINGMASTER CORPORATION
11415 MELROSE AVENUE

FRANKLIN PARK, ILLINOIS 60131

TELEPHONE: (847) 451-1224

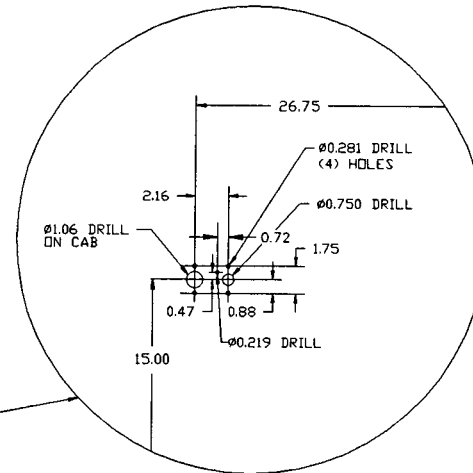
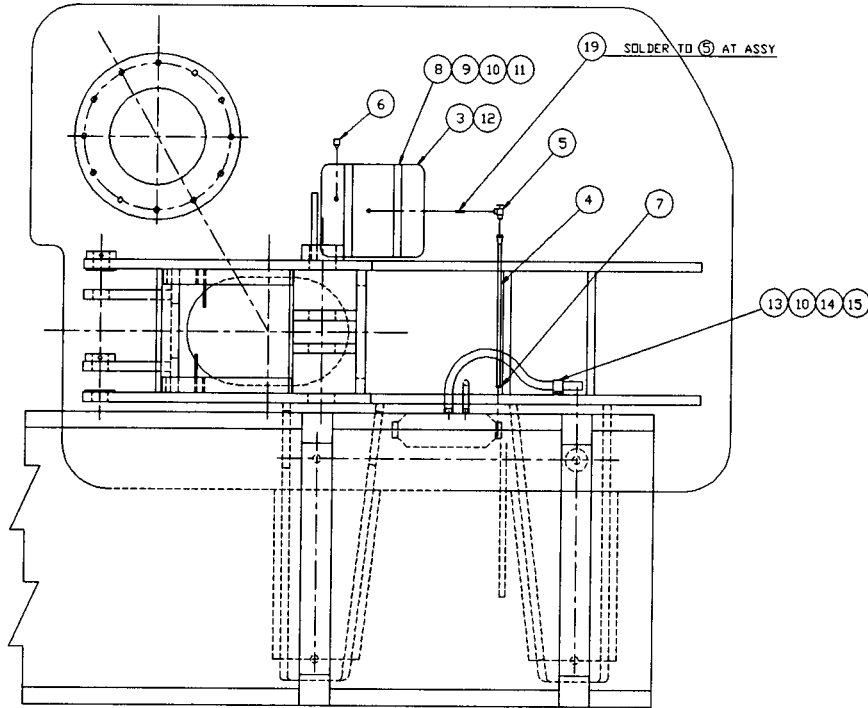

HEATER MOUNTING HOLE PATTERN

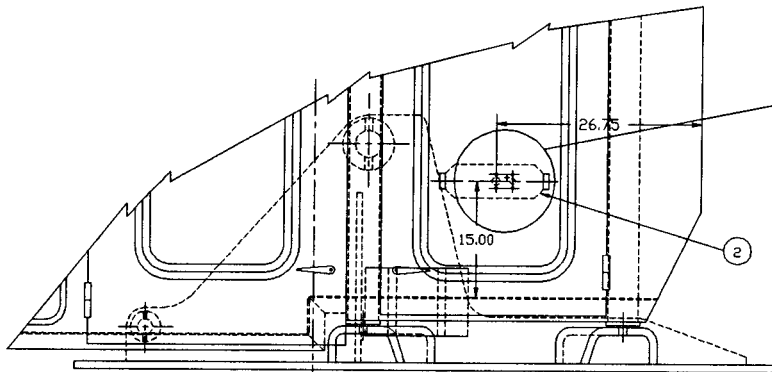

2	11-17-90
REV. NO.	DATE

TOLERANCES UNLESS OTHERWISE SPECIFIED FRACTIONS +/- 3 PLACE DECIMALS +/- 2 PLACE DECIMALS +/- 1 PLACE DECIMALS +/- ANGLES	SWINGMASTER CORPORATION 11415 MELROSE AVENUE FRANKLIN PARK, ILLINOIS 60131	
	HEATER INSTALLATION FDR MODEL 361	
SEE SWINGMASTER SPECIFICATION 0-1 FOR TOLERANCES NOT SPECIFIED DIMENSIONS ARE IN INCHES DO NOT SCALE DRAWING SCALE:	DRAWN BY: J.K. DATE: 12-2-88	DRAWING NO. D-229

MACHINE	SECTION	15
-----	-----	-----
MODEL 361 SWINGLOADER	OPERATOR'S COMPARTMENT	
-----	-----	-----

ASSEMBLY NUMBER	DESCRIPTION
-----	-----
1802230	DIESEL HEATER INSTALLATION
-----	-----

ITEM NO.	PART NUMBER	DESCRIPTION	QTY. USED
-----	-----	-----	-----
2	1802231	DIESEL HEATER ASSEMBLY	1.00
3	1801395	6 GALLON FUEL TANK W/ LOCKABLE CAP	1.00
4	1802232	HOSE ASSEMBLY 2556-4	1.00
5	1802753	NEEDLE VALVE 1/4 TO 1/8 PIPE	1.00
6	1800068	1/8" PIPE PLUG-HEX HEAD	1.00
7	1801618	7/16" DIAMETER HOSE CLAMP	1.00
8	1801479	MOUNTING BRACKET	2.00
9	1800444	H.H.C.S. 5/16-18 X 1 1/4" LONG	4.00
10	1800074	5/16" LOCK WASHER	5.00
11	1800712	2781-8 BULK HOSE/(IN)	4.00
12	1800175	PADLOCK AND KEY	1.00
13	1800744	1 1/2" DIAMETER CLAMP	1.00
14	1800441	H.H.C.S. 5/16-18 X 1/2" LONG	1.00
15	1800550	5/16" FLAT WASHER	1.00
16	1803251	AIR OUTLET MOUNTING BRACKET	1.00
17	1803252	R.H.M.S. #8-32 X 3/8" LONG	3.00
18	1803253	#8 LOCK WASHER	3.00
19	1800728	1/4" DIAMETER HYDRAULIC TUBING/(IN)	1.00
-----	-----	-----	-----

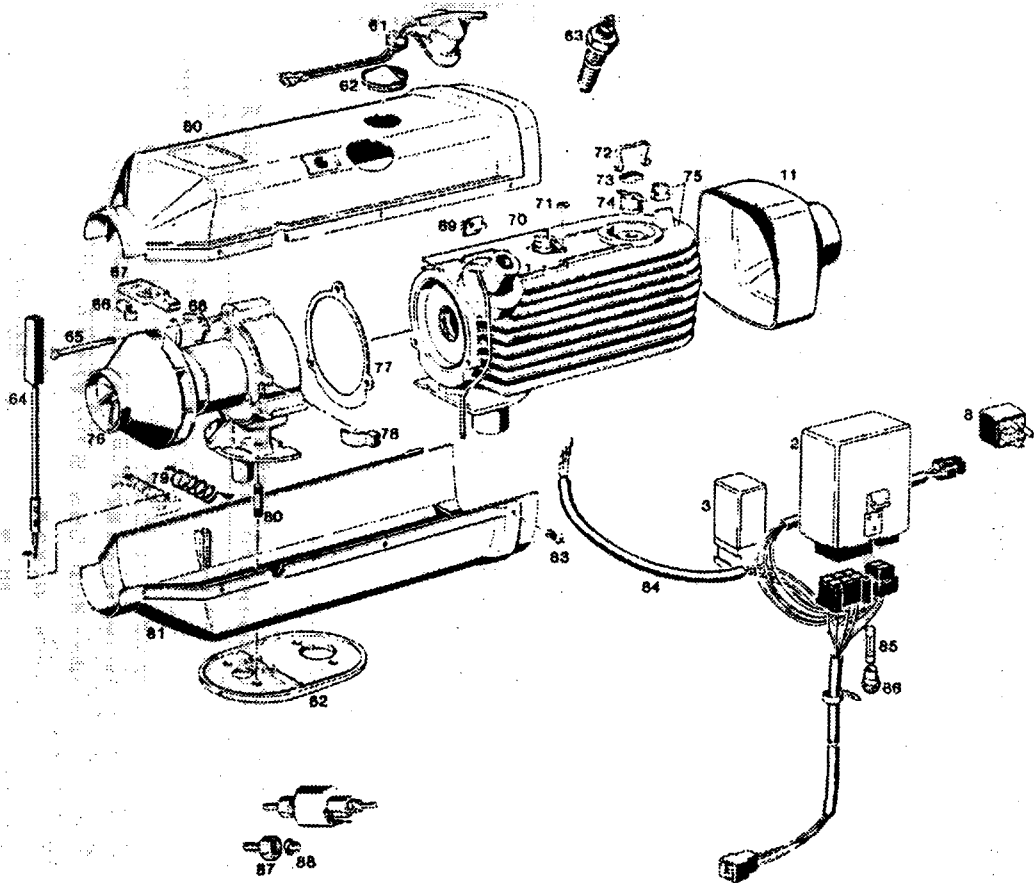
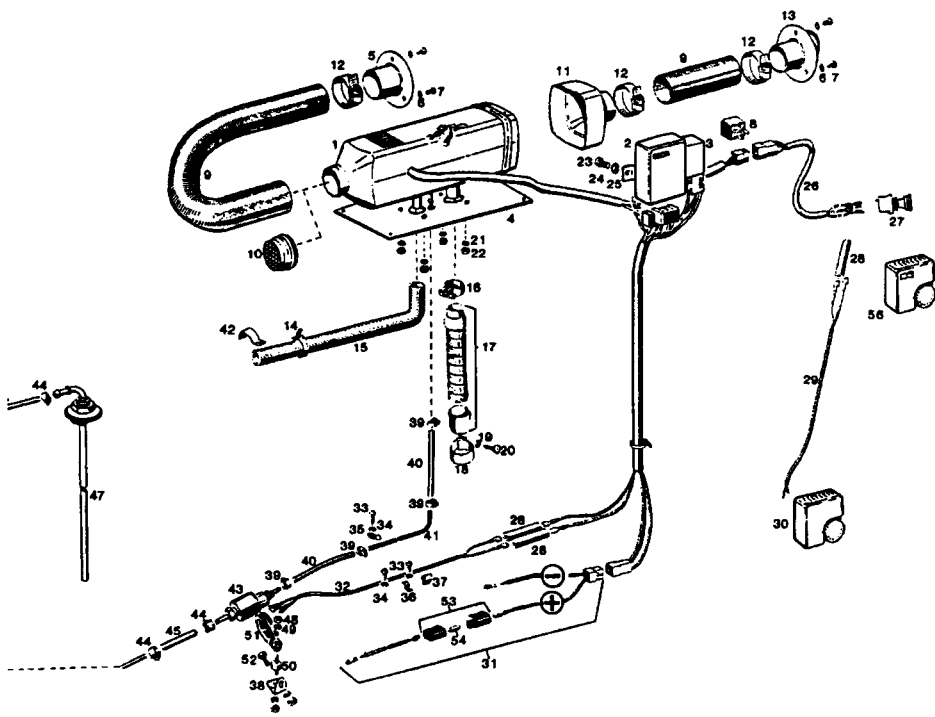

MACHINE	SECTION	15
-----	-----	-----
MODEL 361 SWINGLOADER	OPERATOR'S COMPARTMENT	
-----	-----	-----

ASSEMBLY	DESCRIPTION
NUMBER	-----
1802231	DIESEL HEATER ASSEMBLY
-----	-----

ITEM PART			QTY.
NO.	NUMBER	DESCRIPTION	USED
-----	-----	-----	-----
1	8702547	BASIC HEATER - INCLUDES ITEMS 2,3,43	1
2	8702548	CONTROL UNIT	1
3	8702549	VOLTAGE REGULATOR	1
4	8702550	MOUNTING PLATE	1
5	8702551	AIR INLET FLANGE	1
6		SPRING WASHER B4	6
7		SHEET METAL SCREW B3.9 X 19	6
8		NOT USED ON THIS MODEL	
9	8702552	2" AIR DUCT	2
10	8702553	INLET SAFETY SCREEN	1
11	8702554	AIR OUTLET HOOD	1
12	8702555	2" CLAMP	3
13	8702556	ADJUSTABLE AIR OUTLET	1
14		PLASTIC TIE	1
15	8702557	COMBUSTION AIR HOSE	1
16	8702558	EXHAUST CLAMP	1
17	8702559	FLEXIBLE EXHAUST PIPE	1
18	8702560	EXHAUST PIPE HOLDER	1
19		SPRING WASHER B6	1
20		SHEET METAL SCREW B6.3 X 13	1
21		SPRING WASHER B6	4
22		HEXAGON NUT M6	4
23		SHEET METAL SCREW B4.8 X 13	1
24		SPRING WASHER B4	1
25	8702561	CONTROL UNIT HOLDER	1
26	8702562	SWITCH HARNESS (15')	1
27-30		NOT USED ON THIS MODEL	
-----	-----	-----	-----

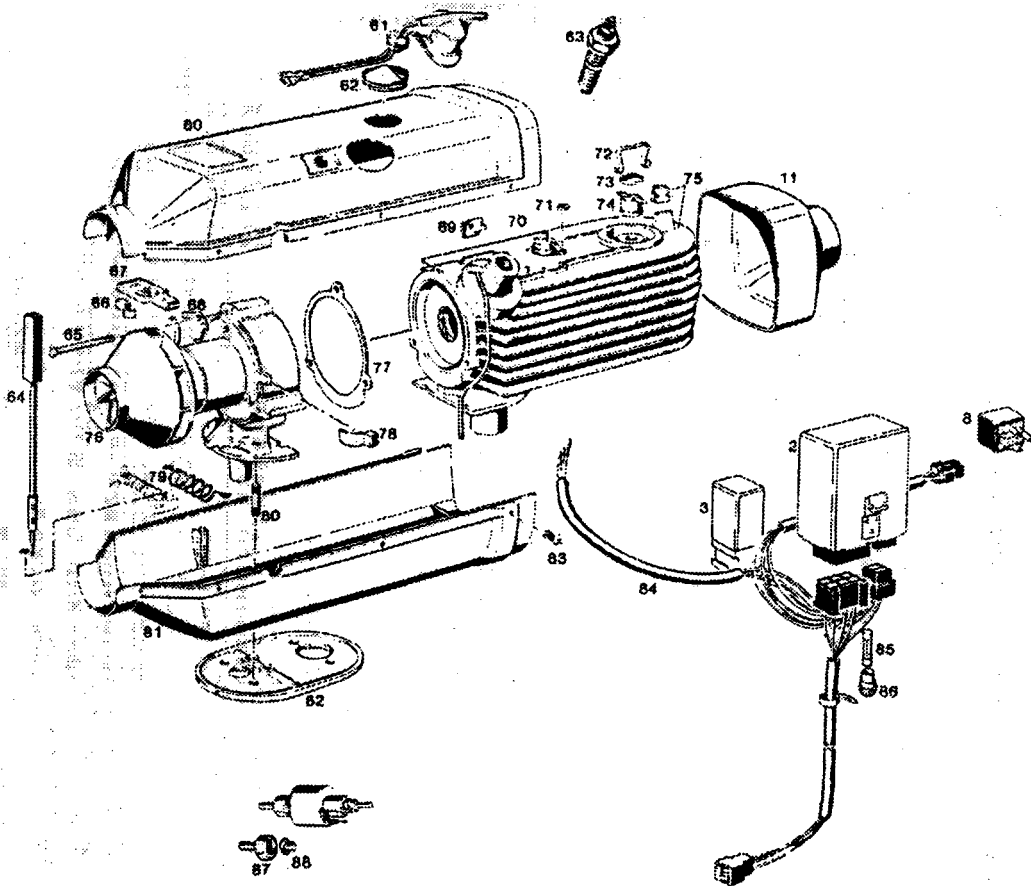
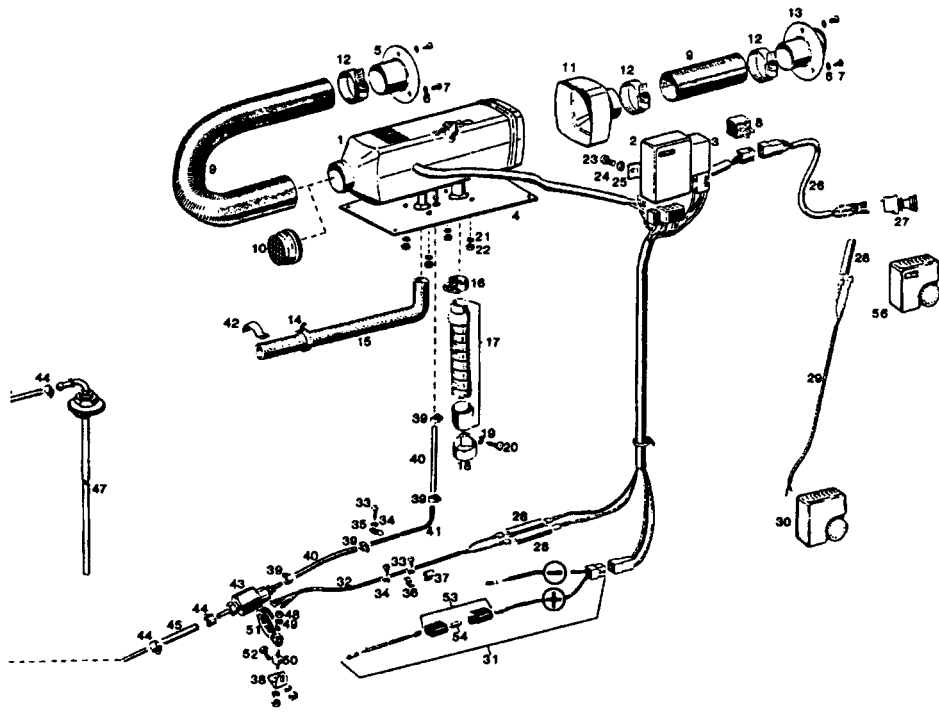

MACHINE _____ SECTION _____ 15

 MODEL 361 SWINGLOADER OPERATOR'S COMPARTMENT

ASSEMBLY _____
 NUMBER DESCRIPTION

 1802231 DIESEL HEATER ASSEMBLY

ITEM NO.	PART NUMBER	DESCRIPTION	QTY. USED
31	8702563	POWER HARNESS (15')	1
32	8702564	FUEL PUMP HARNESS (10')	1
33		SHEET METAL SCREW B3.9 X 9.5	3
34		SPRING WASHER B4	3
35	8702565	HOLDING CLIP	1
36	8702566	HOLDING CLIP	1
37	8702567	CABLE MOUNT	1
38	8702568	FUEL PUMP MOUNTING BRACKET	1
39	8702569	CABLE - 7MM	4
40	8702570	CONNECTION LINE 3.5MM	2
41	8702571	FUEL LINE - CLEAR - 1.5MM	1
42	8702572	COMBUSTION AIR HOSE HOLDER	1
43	8702573	FUEL METERING PUMP	1
44	8702574	CLAMP 10MM	4
45	8702575	CONNECTION LINE 5.0MM	2
46	8702576	FUEL LINE - BLACK - 2.0MM	1
47	8702577	FUEL PICK-UP PIPE	1
48		HEXAGON NUT M6	1
49		SPRING WASHER B6	1
50	8702578	RUBBER MOUNT	1
51	8702579	FUEL PUMP HOLDER	1
52		HEXAGON BOLT M6 X 12	1
53-55		NOT USED ON THIS MODEL	
56	8702580	ELECTRONIC ROOM THERMOSTAT WITH SWITCH	1
60	8702581	UPPER CASE HALF	1
61	8702582	GLOW PLUG HARNESS	1
62	8702583	RUBBER COVER	1

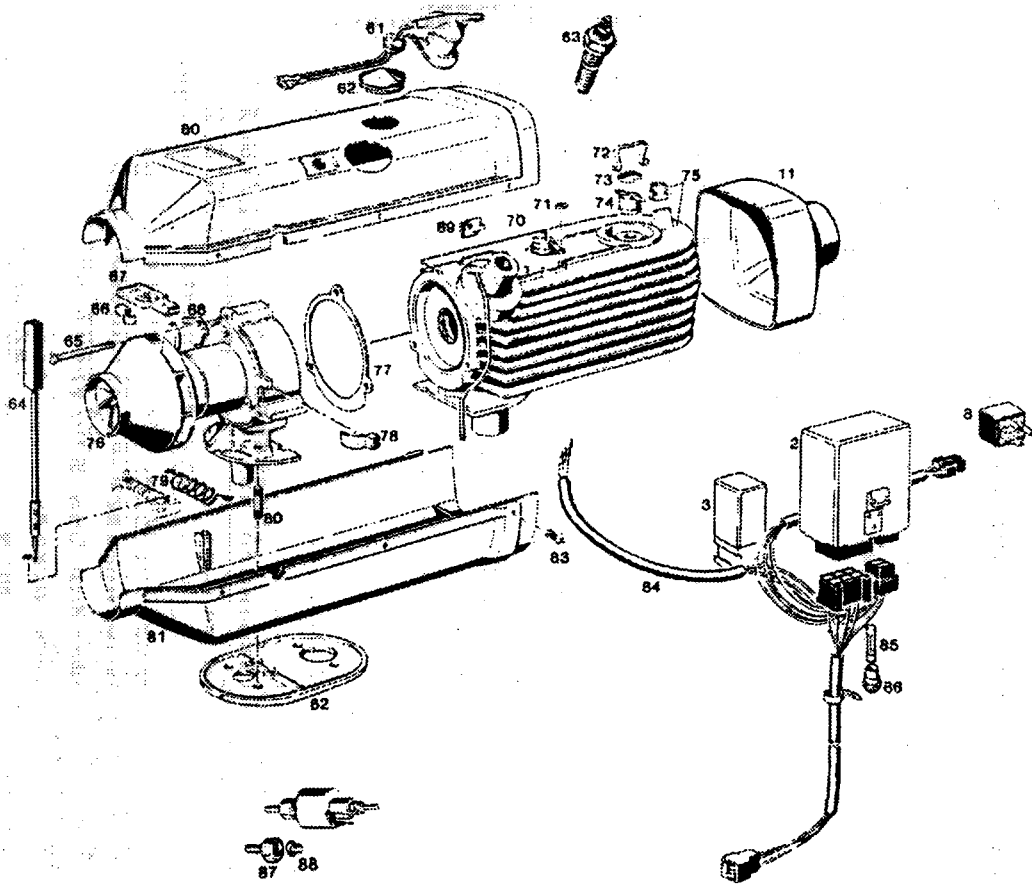
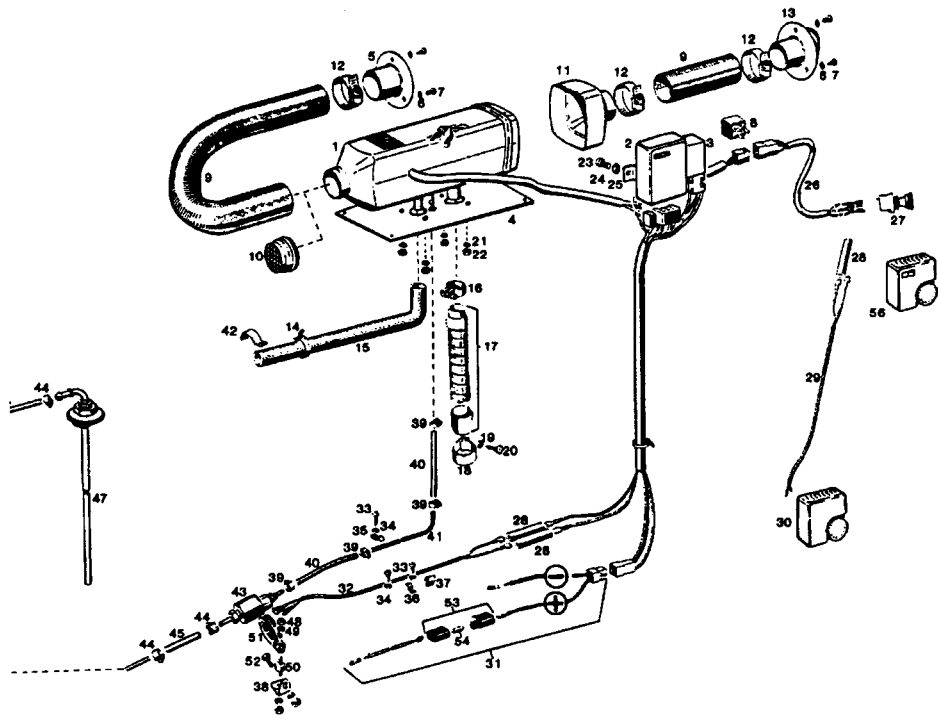

MACHINE	SECTION	15
-----	OPERATOR'S COMPARTMENT	-----
MODEL 361 SWINGLOADER		
-----		-----

ASSEMBLY	DESCRIPTION
NUMBER	
-----	-----
1802231	DIESEL HEATER ASSEMBLY
-----	-----

ITEM PART		QTY.
NO. NUMBER	DESCRIPTION	USED
-----	-----	-----
63	8702584 GLOW PLUG	1
64	NOT USED ON THIS MODEL	
65	8702585 MOUNTING SCREW M5 X 45	3
66	8702586 HOLDING CLIP	1
67	8702587 3 WAY CONNECTOR	1
69	8702588 CABLE HOLDER	1
70	8702589 OVERHEAT CUTOUT SWITCH	1
71	8702590 HOLDING CLIP	1
72	8702591 HOLDING CLIP	1
73	8702592 CERAMIC HOLDER	1
74	8702593 TEMPERATURE SWITCH	1
75	8702594 HEAT EXCHANGER	1
76	8702595 BLOWER MOTOR ASSEMBLY	1
77	8702596 1.0MM GASKET (RED)	1
77	8702597 1.5MM GASKET (WHITE)	1
NOTE: WHEN REPLACING ITEM 77, PLEASE ENSURE THAT YOU USE		
THE SAME THICKNESS GASKET AS USED ORIGINALLY.		
78	8702598 HOLDING CLIP	1
79	NOT USED ON THIS MODEL	
80	8702599 MOUNTING STUD M6 X 20	2
81	8702600 LOWER CASE HALF	1
82	8702601 SILICONE MOUNTING GASKET	1
83	8702602 RIVET	6
84	8702603 MAIN HEATER HARNESS	1
85	8702604 FUSE	1
86	8702605 FUSE CAP	1
87	8702606 FUEL METERING PUMP FILTER CAP	1
88	8702607 FUEL FILTER	1