



SECTION D  
WHEELS AND TIRES

---

SWINGMASTER CORPORATION

PARTS BOOK

---

MACHINE

SECTION

-----  
MODEL 361 SWINGLOADER  
-----

-----  
WHEELS AND TIRES  
-----

DESCRIPTION

-----  
WHEEL AND TIRE ASSEMBLY - XR TYPE 16.00-25

    WHEEL ASSEMBLY - 11.25STN - 25 RIM - SINGLE DISH  
-----

---

SWINGMASTER CORPORATION

11415 MELROSE AVENUE

FRANKLIN PARK, ILLINOIS 60131

TELEPHONE: (847) 451-1224

---

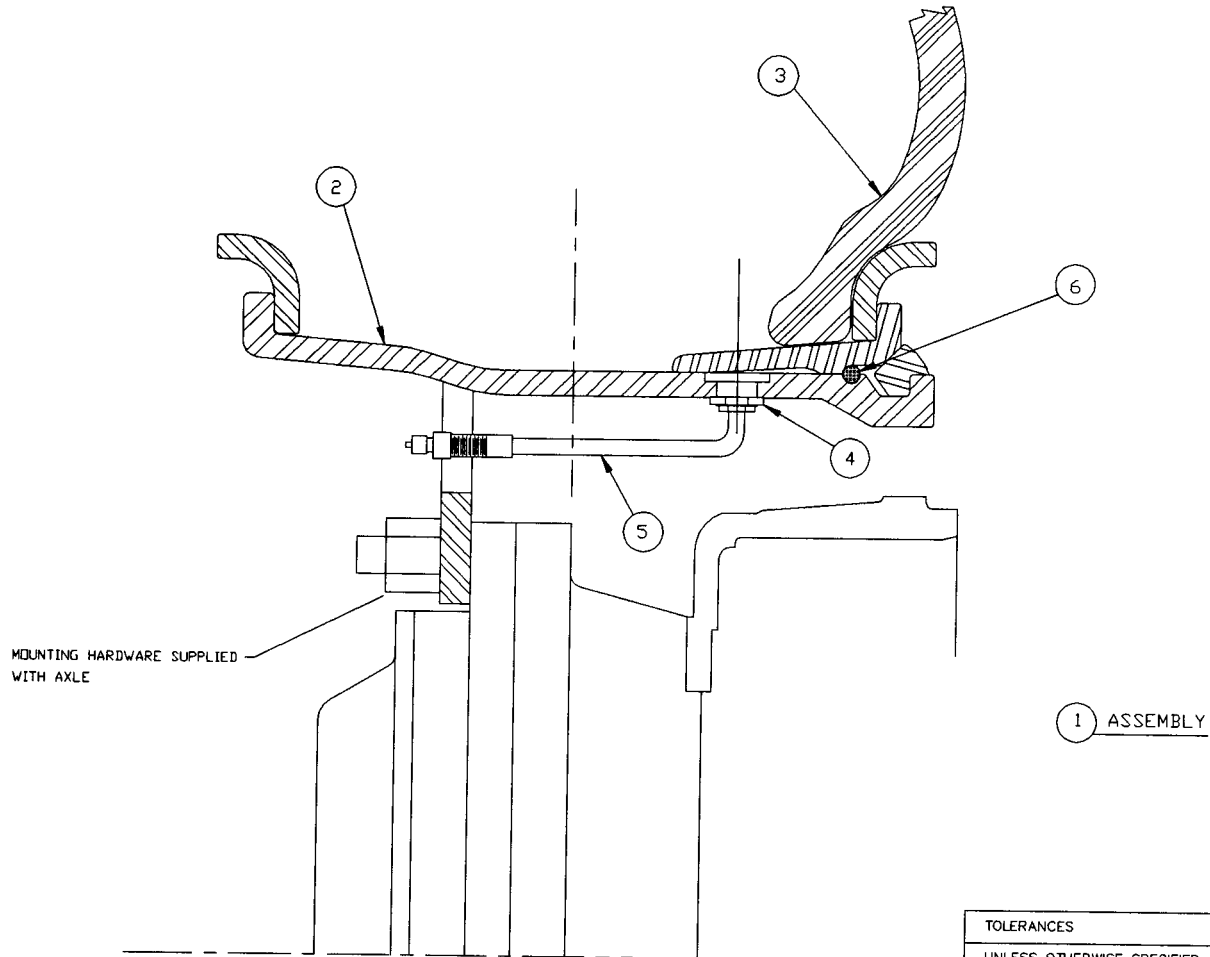

TOLERANCES  
 UNLESS OTHERWISE SPECIFIED  
 FRACTIONS +/-  
 3 PLACE DECIMALS +/-  
 2 PLACE DECIMALS +/-  
 1 PLACE DECIMALS +/-  
 ANGLES

SEE SWINGMASTER SPECIFICATION  
 C-1 FOR TOLERANCES NOT SPECIFIED

DIMENSIONS ARE IN INCHES  
 DO NOT SCALE DRAWING  
 SCALE: 1/2

**SWINGMASTER CORPORATION**  
 11415 MELROSE AVENUE  
 FRANKLIN PARK, ILLINOIS 60131

WHEEL & TIRE ASS'Y  
 16.00 - 25 TUBELESS TIRE  
 MODEL 361

DRAWN BY: B.W.      DRAWING NO.  
 DATE: 9-27-88      C-102

|         |         |
|---------|---------|
| 1       | 10-2-89 |
| REV.NO. | DATE    |

MACHINE

SECTION

4

MODEL 361 SWINGLOADER

WHEELS AND TIRES

ASSEMBLY  
NUMBER

DESCRIPTION

1805393  
TIRE

WHEEL AND TIRE ASSEMBLY - 16.00X25

| ITEM NO. | PART NUMBER | DESCRIPTION             | QTY. USED |
|----------|-------------|-------------------------|-----------|
| 002      | 1802075     | WHEEL ASSEMBLY          | 1.00      |
| 003      | 1805394     | TIRE, HARD ROCK LUG E-3 | 1.00      |
| 004      | 1802077     | TUBELESS SPUD           | 1.00      |
| 005      | 1802078     | VALVE STEM              | 1.00      |
| 006      | 8704002     | O-RING                  | 1.00      |

MACHINE

SECTION

4

-----  
MODEL 361 SWINGLOADER  
-----

-----  
WHEELS AND TIRES  
-----

ASSEMBLY

NUMBER

DESCRIPTION

-----  
1805395  
-----

-----  
WHEEL AND TIRE ASSEMBLY - 16.00X25 TIRE  
-----

ITEM PART

NO. NUMBER DESCRIPTION

QTY.

USED

|     |         |                     |      |
|-----|---------|---------------------|------|
| 002 | 1802075 | WHEEL ASSEMBLY      | 1.00 |
| 003 | 1805396 | TIRE, RL-2F E- GRIP | 1.00 |
| 004 | 1802077 | TUBELESS SPUD       | 1.00 |
| 005 | 1802078 | VALVE STEM          | 1.00 |
| 006 | 8704002 | O-RING              | 1.00 |

---

---

SWINGMASTER CORPORATION

11415 MELROSE AVENUE

FRANKLIN PARK, ILLINOIS 60131

TELEPHONE: (847) 451-1224

---

---

SWINGMASTER CORPORATION

PARTS BOOK

---

MACHINE

SECTION

4

-----  
MODEL 361 SWINGLOADER  
-----

-----  
WHEELS AND TIRES  
-----

ASSEMBLY

NUMBER

DESCRIPTION

-----  
1802074  
-----

-----  
WHEEL AND TIRE ASSEMBLY- 16.00 X 25 TIRE  
-----

ITEM PART

NO. NUMBER DESCRIPTION

QTY.

USED

-----

|   |         |                                  |      |
|---|---------|----------------------------------|------|
| 2 | 1802075 | WHEEL ASSEMBLY                   | 1.00 |
| 3 | 1802076 | 16.00 X 25 XR TYPE TUBELESS TIRE | 1.00 |
| 4 | 1802077 | TUBELESS SPUD                    | 1.00 |
| 5 | 1802078 | VALVE STEM                       | 1.00 |
| 6 | 8701853 | O-RING                           | 1.00 |

-----

---

SWINGMASTER CORPORATION

11415 MELROSE AVENUE

FRANKLIN PARK, ILLINOIS 60131

TELEPHONE: (847) 451-1224

---

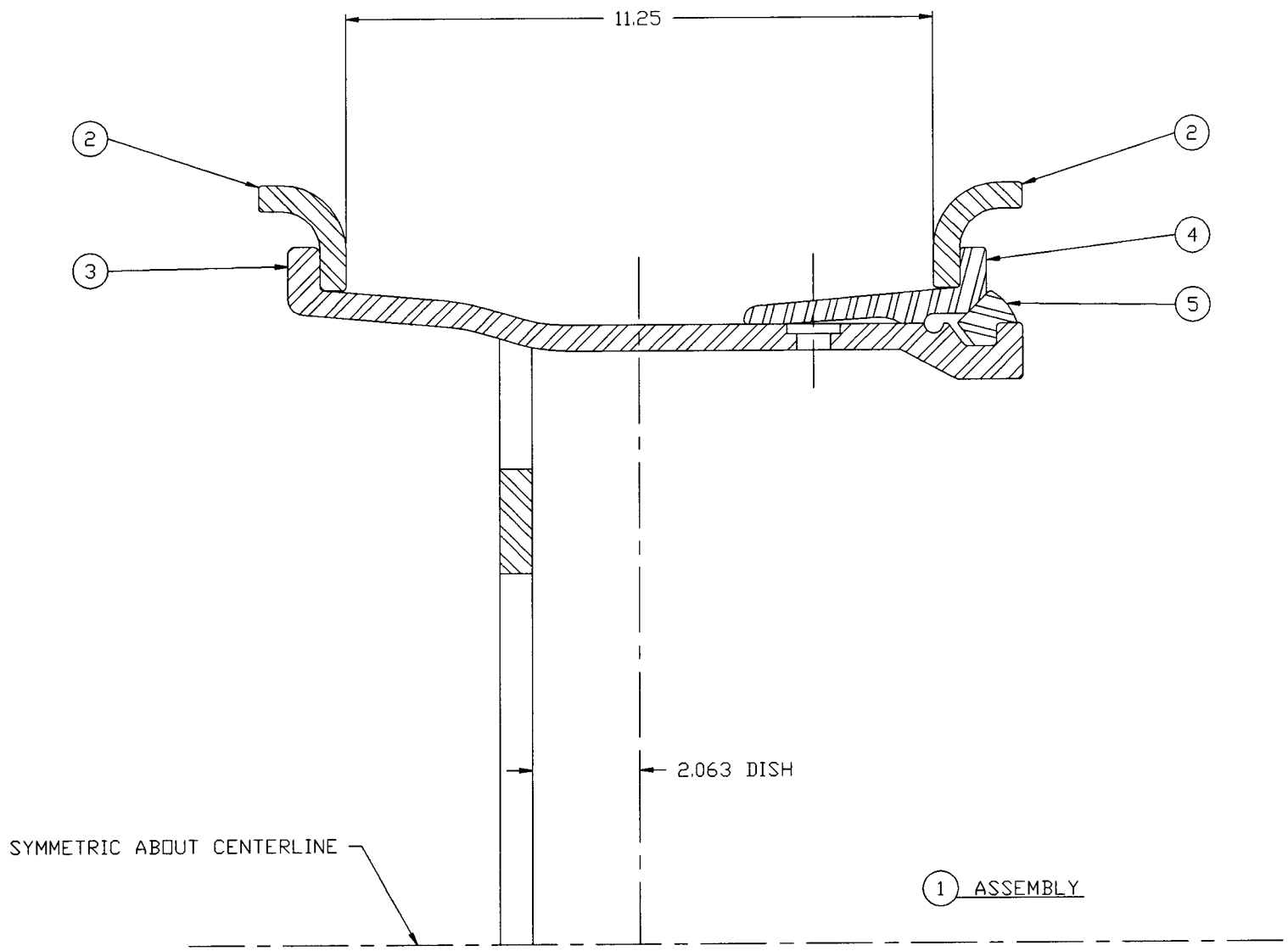

---

SWINGMASTER CORPORATION

PARTS BOOK

---

MACHINE

SECTION

4

-----  
MODEL 361 SWINGLOADER  
-----

-----  
WHEELS AND TIRES  
-----

ASSEMBLY  
NUMBER

DESCRIPTION

-----  
1802075

-----  
WHEEL ASSEMBLY - 11.25STN - 25 RIM - SD  
-----

ITEM PART

NO. NUMBER DESCRIPTION

QTY.  
USED

-----  
2 8701856 FLANGE  
3 8701855 BEAD SEAT BAND  
4 8701854 LOCK RING  
-----

2  
1  
1  
-----

---

SWINGMASTER CORPORATION  
11415 MELROSE AVENUE  
FRANKLIN PARK, ILLINOIS 60131

TELEPHONE: (847) 451-1224

---